

mec.pump

Idropulitrice ad alta pressione – H.P. Cleaner

STARJET

TAVOLE RICAMBI – SPARE PARTS LIST

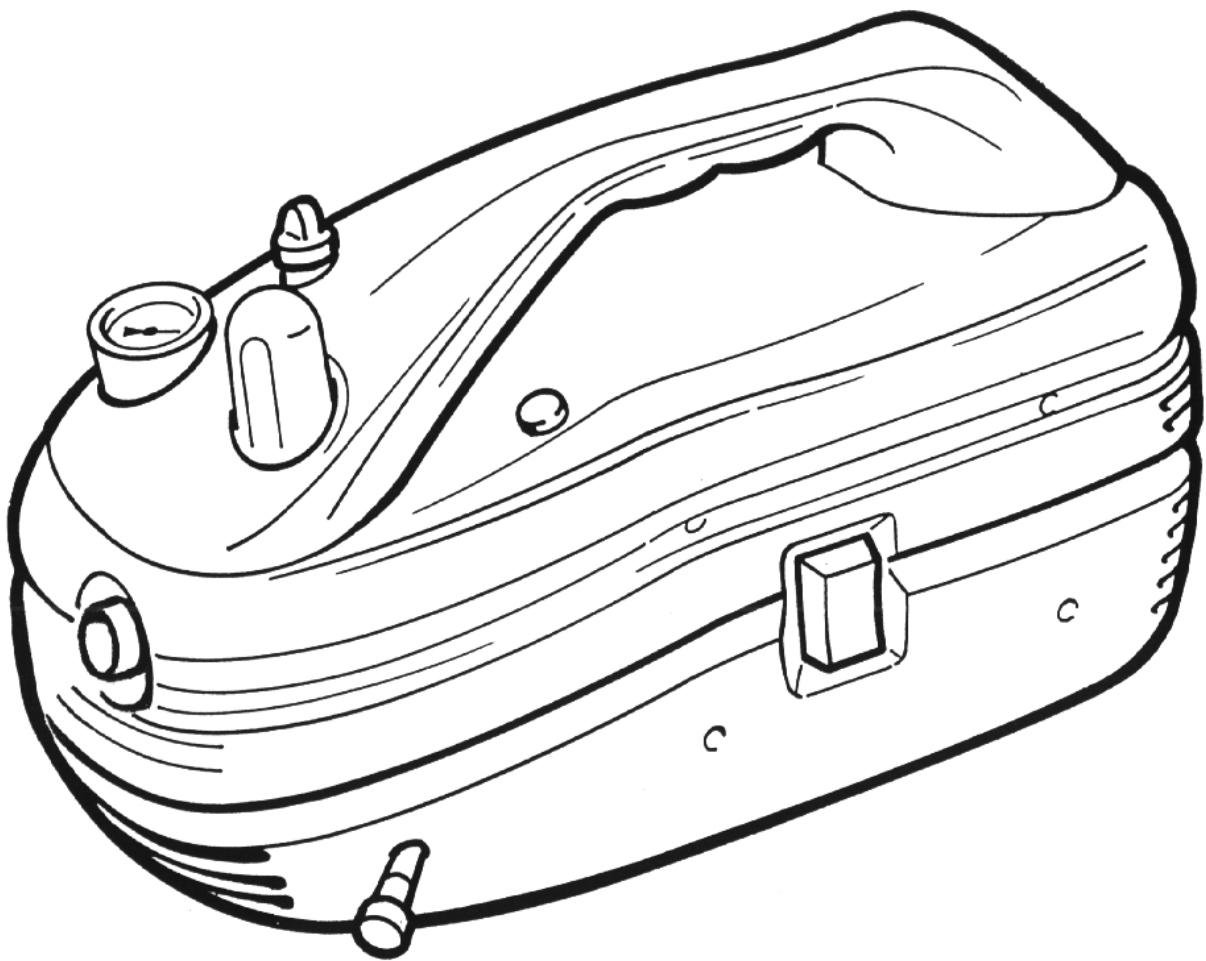

Rev. 03.03

Pos.	Codice/code	Descrizione	Description	Pcs
		STARJET	STARJET	
1	1216001002	Pomolo reg. pressione	Knob	1
2	1322001002	Vite 8x30	Screw	1
3	1304001002	Dado	Nut	2
4	1401001002	Astuccio molla	Spring box	1
5	1516001002	Piattello molla	Spring plate	2
6	1613001002	Molla valvola	Spring	1
7	1416001002	Pistoncino valvola	Valve piston	1
8	1815001002	Or 2031	O ring	1
9	1403001002	Camicia pistoncino valvola	Valve piston liner	1
10	1815002002	Or 2056	O ring	1
11	1407001002	Guida spillo valvola	Valve pin guide	1
12	1815003002	Or 108	O ring	1
13	1815004002	Or 2012/101	O ring	2
14	1719001002	Spillo valvola	Valve pin	1
15	1913001002	Manometro 0-160 bar	Manometer	1
16	1416002002	Porta manometro 1/8	Gauge holder	1
17	1420001002	Tappo valvola ottone	Valve screw	5
18	1815005002	Or 2062	O ring plug	6
19	1407002002	Gabbietta valvolina	Valve housing	6
20	1613002002	Molla valvolina	Spring valve	6
21	1719002002	Spillo valvolina	Valve pin	6
22	1419001002	Sede valvolina plastica	Valve seat (plastic)	6
22b	1419002002	Sede valvolina acciaio	Valve seat (stainless steel)	6
23	1815006002	Or 2050	Or valve	6
24	1420002002	Tappo 1/4	Plug 1/4	1
25	2106004002	Filtro aspirazione D.20	Suction filter	1
26	1416014002	Prolunga 3/8Mx1/2M L.58	Extension	1
27	1302001002	Brugola T	Screw	4
28	1601006002	Anello antiestrusione	Ring	1
29	1815005002	Or 2062	O ring	1
30	1418002002	Raccordo aspiraz. detergente	Suction tail	1
31	1613003002	Molla	Spring	1
32	2319001002	Sfera aisi	Aisi ball	1
33	1416004002	Porta tubo detergente	Det. hose fitting	1
34	2420001002	Tubo detergente	Detergent hose	1
35	2106002002	Filtro di fondo D.15 ptg D.8	Filter	1
36	1613004002	Molla	Spring	1
37	1719003002	Spillo ritegno ottone	Retention pin (brass)	1
37	1719004002	Spillo ritegno plastica	Retention pin (plastic)	1
38	1815008002	Or 2021/104	O ring	1
39	2520002002	Testina alluminio	All. pumphead	1
39	2520005002	Testina alluminio x Stop&Go	All. pumphead for Stop&Go	1
39	2520001002	Testina ottone	Brass pumphead	1
39	2520006002	Testina ottone x Stop&Go	Brass pumphead for Stop&Go	1
a40	1807001002	Guarnizione 22x15x5	V packing meg	3
b40	1807002002	Guarnizione 15x22x4	V packing	3
41	1416005002	Porta guarnizione	V packing holder	3
42	1404001002	Disco battuta	Beatplate	3
43	1816001002	Paraolio 15x24x5	Oil seal	3
44	1302002002	Bullone brugola 8x25	Screw	4
45	1420003002	Tappo livello olio	Oil dipstick	1
46	2819001002	Serbatoio olio	Oil tank	1
47	2903001002	Corpo pompa alluminio	Body	1
48	1613005002	Molla pistone	Piston spring	3
49	3016003002	Pistone acciaio	Steel piston	3
49	3016001002	Pistone ceramizzato	Ceramic piston	3
50	1616001002	Porta molla	Spring retainer	3
51	1518001002	Ralla di spinta D.60	Thrust bearing	1
52	3103001002	Cuscinetto a rulli	Roller bearing	1
53	1518002002	Ralla	Bearing	1
54	1516002002	Piattello inclinato 8.15	Eccentric wobble	1

Pos.	Codice/code	Descrizione	Description	Pcs
		STARJET	STARJET	
55	3103002002	Cuscinetto 7204 B	Bearings	1
56	1816002002	Paraolio 20x35x7	Oilseal	1
57	1815009002	Or 4325	O ring	1
58	1304002002	Dado	Nut	4
59	3206001002	Flangia ant. Mec80	Flange	1
60	1815011002	Or 2100	O ring	3
61	1216002002	Piedini in gomma	Foot	4
62	1322010002	Vite	Screw	4
63	3306001002	Coprifaston	Faston cover	4
64	3306002002	Faston	Faston	4
65	3303002002	Cappello	Fastening plug	2
66	3306003002	Fermacavo	Cable holder	1
67	1613006002	Molla porta condensatore	Bracket	1
68	3403001002	Condensatore 32/35mf	Capacitor 32/35mf	1
69	1318001002	Rondella	Washer	1
70	4919001002	Simbolo terra	Earth symbol	1
71	1322003002	Vite	Screw	1
72	5009001002	Isolante	Insulator	1
73	1807003002	Guarnizione	Gasket	1
74	1203001002	Coprimorsettiera	Term. board. cov.	1
75	1322004002	Vite	Screw	4
76	3509001002	Interruttore Bip. Lum.	Switch	1
77	3603001002	Cavo elettrico	Cable	1
78	3302003002	Blocca cavo PG13,5	Cable lock	1
79	4703001002	Carenatura Destra SJ	Rightside cover	1
80	1322005002	Vite	Screw	2
81	1322010002	Vite 4,8x19	Screw	8
82	4703002002	Carenatura sinistra SJ	Leftside cover	1
83	4803001002	Chiavetta	Key	1
84	1322012002	Vite interruttore	Screw	2
85	3918002002	Rotore 65/100	Rotor	1
86	1320001002	Tirante	Tie rod	4
87	3103003002	Cuscinetto 6204 ZZ	Ball bearing	1
88	3219001002	Scudo post Mec80	Front cover	1
89	5222001002	Ventola FB80	Fan	1
90	1822002002	V ring	V ring	1
91	5203001002	Copri ventola FCN80	Fan cover	1
92	1322007002	Vite	Screw	4
93	1116001002	Pistola autom. c/prolunga	Autom. gun	1
94	2420010002	Tubo a.p. mt.7 F1/4	High pressure hose	1
95	1112001002	Lancia (Prolunga SF3)	Lance	1
96	1402001002	Bussola Testina	Head bush	1
97	1416015002	Portagomma plast 1/2+3/4	Water hose con.	1
98	1601001002	Anello compensatore 47	Compensating ring	1
99	3716001002	Pacco stat. Mec80 220v 50hz	Motor cage 220v 50hz	1
99	3716005002	Pacco stat. Mec80 220v 60hz	Motor cage 220v 60hz	1
99	3716007002	Pacco stat. Mec80 240v 50hz	Motor cage 240v 50hz	1
100	3503001002	Copri interruttore in gomma	Switch cover	1
101	3513001002	Mascherina interruttore	Border switch	1
102	1112012002	Lancia completa (T10)	Gun complete	1
103	1113003002	Multireg A.L. (T10)	Multireg	1
104	1112013002	Lancia c/multireg A.L.	Lance + multireg	1
105	1722003002	Valvolina asp/mand	Valve	6
106	1118001002	Raccordo lancia M22	Lance pipe fitting	2
107	1120001002	Tubo interno lancia SF3	Inner pipe lance	2
108	1103001002	Copertura plast. lancia SF3	Plastic covering	2
109	1101001002	Attacco rapido M22 per lancia	Quick coupling	1
110	1116004002	Pistola "Top Line" A.L.	Trigger gun	1
111	1815012002	Or 106	O ring	2
KIT 10	5311010002	Kit 10 - Tenute pistoni ceramica	Kit 10 for ceramic pistons	3

TAV. A - STARJET - ASSIEME COMPLETO - MAIN VIEW

mec-pump
STARJET

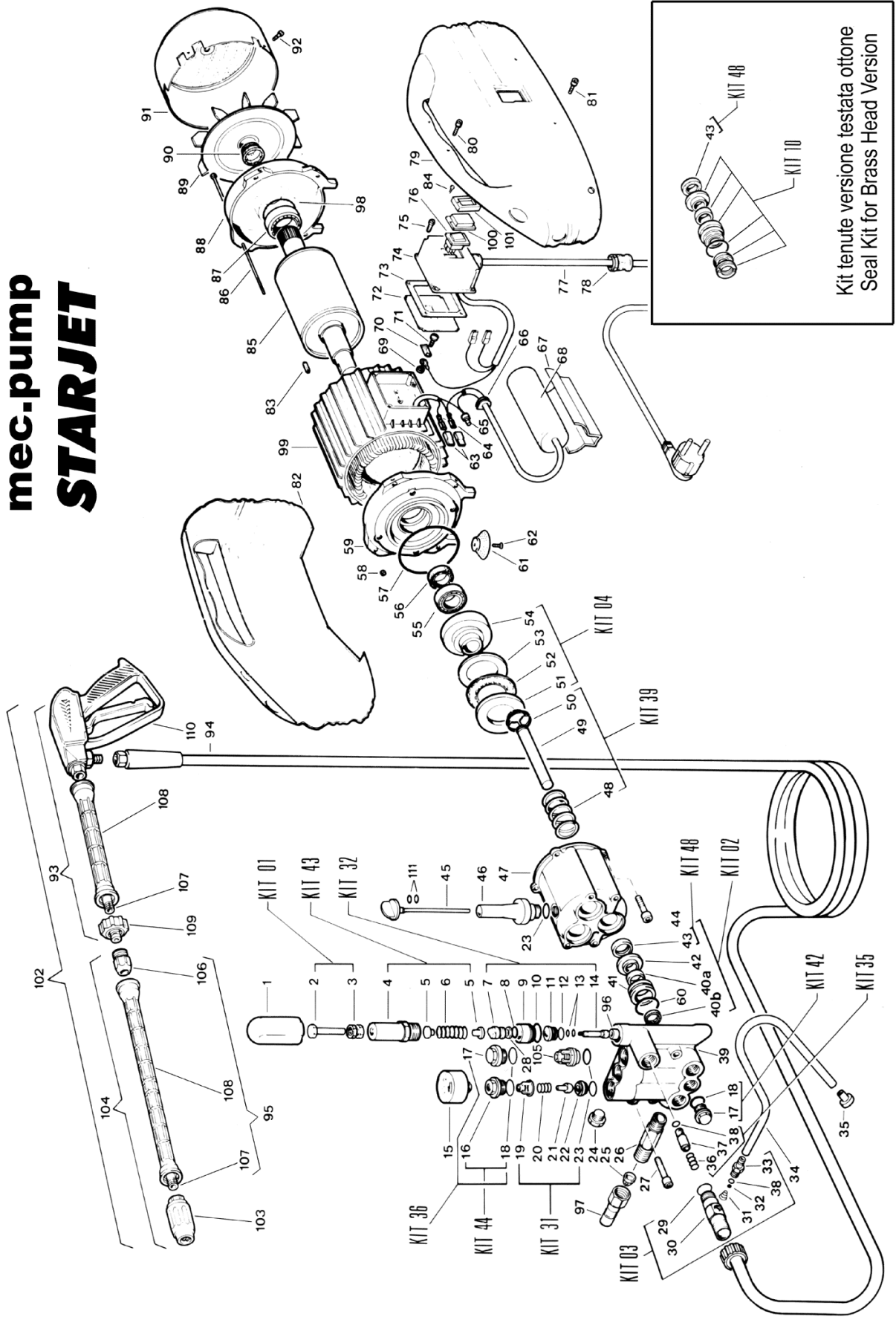

Kit tenuta versione testata ottone
Seal Kit for Brass Head Version